

Features & Benefits

- To be mounted on the exhaust port of a solenoid valve to protect internal parts from the environment



General

| | |
|---------------------------|----------------------------|
| Operating pressure | 0 to 10 bar (1) (2) (3) |
| Fluid temperature range | -10°C to +80°C (1) (2) (3) |
| Ambient temperature range | -10°C to +80°C (1) (2) (3) |
| Load loss | Minimum |

Specifications

| Construction | (1) | (2) |
|------------------|----------------|---------------|
| body | porous plastic | porous bronze |
| connection piece | plastic | brass |
| Pipe size | Catalog number | |
| | - | (set of 2) |
| Ø M5 | 34600405 | - |
| G 1/8 | 34600406 | 97701875 |
| G 1/4 | 34600407 | 97701876 |
| G 3/8 | 34600408 | - |
| G 1/2 | 34600409 | - |

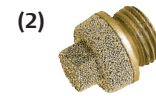

| Construction | (3) | | |
|------------------|---------------------|------------------|----------|
| body | stainless steel | | |
| connection piece | nickel plated brass | | |
| | M | G (ISO 228/1) | NPT |
| Pipe size | Catalog number | | |
| Ø M5 | 34600484 | - | - |
| 1/8" | - | 34600418 | 34600482 |
| 1/4" | - | 34600419 | 34600483 |
| 3/8" | - | 34600478 | - |
| 1/2" | - | 34600479 | 34600481 |



Dimensions (mm), Weight (kg)

Silencer (1) - Exhaust Protector (2) (3) - Performance Exhaust Protector (4)

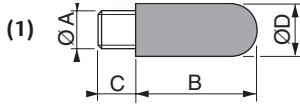

| Catalog number | ØA | B | C | ØD | weight |
|----------------|------|------|------|------|--------|
| 34600405 | M5 | 17.5 | 4 | 6.5 | 0.0005 |
| 34600406 | G1/8 | 28.5 | 5.5 | 12.5 | 0.002 |
| 34600407 | G1/4 | 34.5 | 8 | 15.5 | 0.004 |
| 34600408 | G3/8 | 56 | 11.5 | 18.5 | 0.006 |
| 34600409 | G1/2 | 66.5 | 11 | 23.3 | 0.010 |

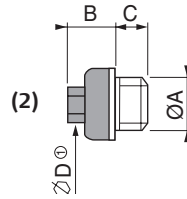

| Catalog number | ØA | B | C | ØD | weight |
|----------------|-------|----|---|----|--------|
| 97701875 | G 1/8 | 7 | 5 | 7 | 0.004 |
| 97701875 | G 1/4 | 10 | 6 | 9 | 0.010 |

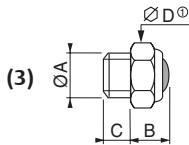

| Catalog number | ØA | B | C | ØD | weight |
|----------------|-------|-----|-----|----|--------|
| 34600484 | M5 | 4.5 | 3.2 | 8 | 0.001 |
| 34600418 | G 1/8 | 10 | 6 | 13 | 0.006 |
| 34600419 | G 1/4 | 11 | 8 | 16 | 0.010 |
| 34600478 | G 3/8 | 11 | 9 | 19 | 0.014 |
| 34600479 | G 1/2 | 14 | 9 | 24 | 0.023 |

① D: Across flats